

GALBRAITH PARK MASTER PLAN

JANUARY 2026

Purpose of this document

This Master Plan sets out the long-term vision for Galbraith Park, realising its potential as a regional destination that reconnects the community with nature. With a clear design direction - aiming to integrate cultural, natural and playful experiences - the Master Plan establishes a spatial program for Galbraith Park, identifying key zones and the elements that will activate them. Developed to unify effort and attract investment, the Master Plan sets out a coordinated approach to delivery - ensuring that early stages contribute to the future

identity of the park and that incremental change builds towards a cohesive, high-quality public environment. As new homes, community facilities and local businesses emerge across Cannonvale, more people will choose to call it home - increasing the demand for public open space. Planning for Galbraith Park now ensures that this growth translates into long-term community benefit. By investing with intention, Galbraith Park can become a defining feature of Cannonvale's identity and a lasting legacy for future generations.

01	Introduction	
	Project context	02
	Project drivers	04
	Vision	06
	Master Plan	08
02	Master Plan detail	
	Community zone	12
	Recreation zone	18
04	Look and feel	
	Character palettes	28

An aerial photograph of a lush green landscape, likely a park or natural area. A prominent white line, possibly a road or a path, winds through the scene from the bottom left towards the top right. The vegetation is dense and vibrant green, with some lighter patches that could be grass or different types of trees. The overall tone is bright and natural.

Project context

Galbraith Park is located in Cannonvale, at the heart of a rapidly growing coastal community that forms part of the Greater Airlie Beach Area. Over the past decade, the region has experienced significant population and economic growth, emerging as one of Queensland's fastest-growing destinations. As Cannonvale evolves into a town centre with a stronger civic identity, there is a clear need for high-quality community infrastructure that supports everyday life. Galbraith Park, set within the Whitsunday open space network, presents an opportunity to fulfil this need - offering a central,

accessible and well-connected site for community gathering, recreation and leisure. As Cannonvale grows into its role as a civic and community hub for the Whitsundays, Galbraith Park has the potential to become its central gathering place - a park that is both recreational and restorative, active and ecological, local and regionally significant. The Master Plan responds to this setting by embracing the park's role as a connector: connecting neighbourhoods to nature, community life to the town centre, and everyday recreation to a broader rewilded landscape.



Whitsunday
Plaza

Saltwater
Creek

Galbraith Park.

The park is uniquely framed by two creek systems - Saltwater Creek to the east and Galbraith Creek to the west - which together define the natural boundary of the reserve. Over the past two decades, these riparian corridors have been rehabilitated, creating a wildlife corridor. Public consultation has reinforced a strong community desire to further restore these areas, improve walking and running trails and create places that celebrate the landscape.

Galbraith
Creek

Shute Harbour Rd

Project drivers



Gather

Gathering is at the heart of Galbraith Park. Through a network of spaces designed for connection and celebration, the park will bring people together - creating a shared backyard for the Whitsundays.



Discover

Discovery at Galbraith Park is about curiosity, learning and immersion - exploring the wild edges and rediscovering the natural systems that shape the Whitsundays.



Play

Play defines the park's social energy - a celebration of freedom, imagination and movement. Beyond equipment, Galbraith Park will offer an immersive landscape, where children learn through nature.



Care

Care defines Galbraith Park's long-term legacy - the spirit of stewardship that protects its landscape and empowers the community - turning biodiversity into an everyday experience.

A vibrant, sunlit park scene featuring a variety of trees, including a large tree with a thick branch in the foreground and several smaller trees in the background. People are seen sitting on a stone bench and taking photos, suggesting a recreational and scenic environment. The overall atmosphere is peaceful and natural.

Vision

A rewilded landscape that connects people with nature, Galbraith Park will become a regional destination. Reimagined as a series of parks, each offering a distinct ecosystem of experiences that celebrate the natural landscape, Galbraith Park will be a place for all to explore.



View to nature walk.

Master Plan



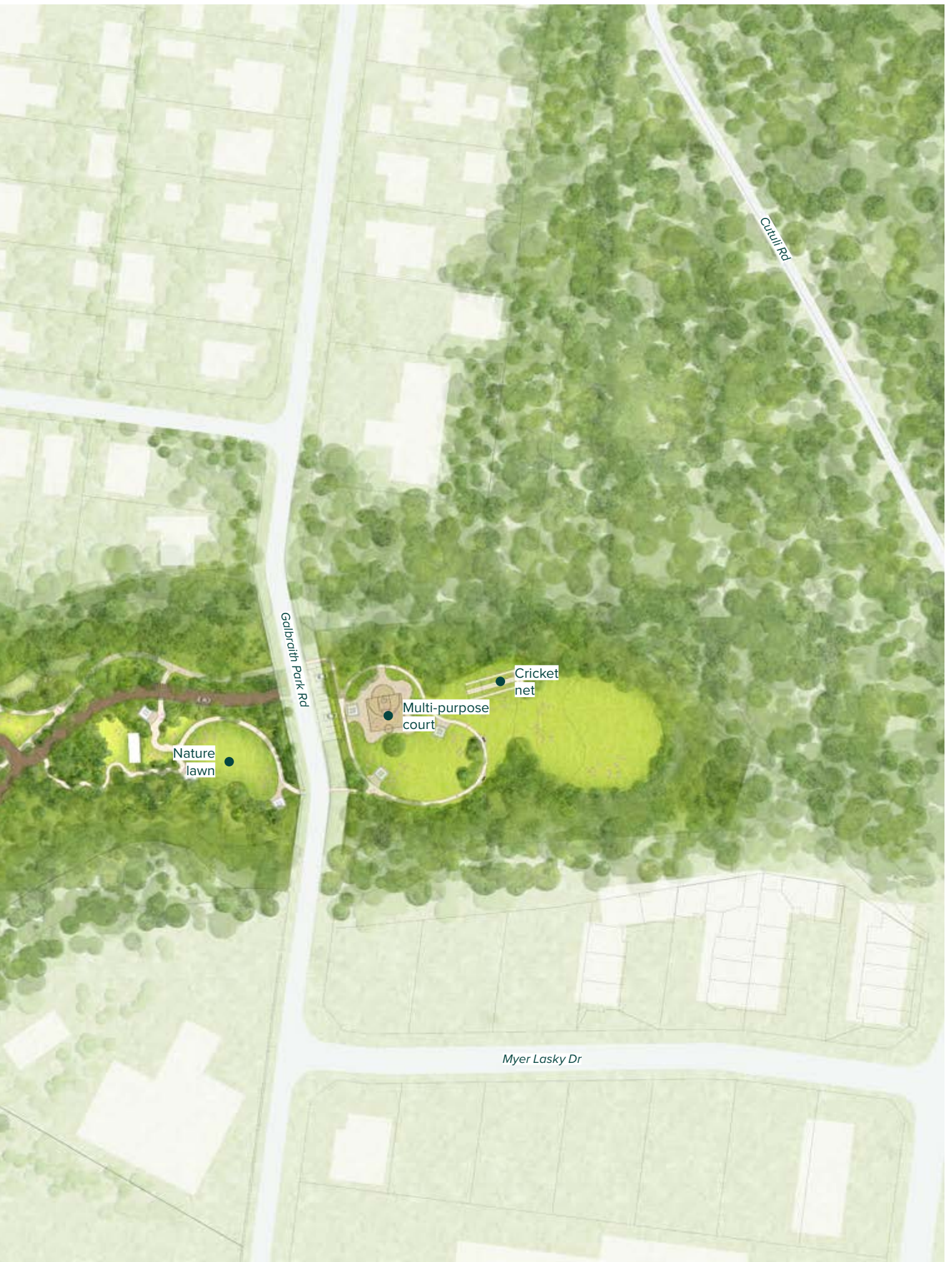

Figure 02

Galbraith Park Master Plan

1:2000



Preliminary delivery



Stage 1 focuses on establishing the foundational elements that will enable the long-term delivery of Galbraith Park. This includes initial earthworks, site preparation, and key enabling infrastructure such as access, services and drainage. The Nature Lawn and Community Pavilion are identified as priority public realm elements to be delivered; however, their construction will depend on budget allocation, and coordinated with the delivery of the Community Centre and its supporting infrastructure.

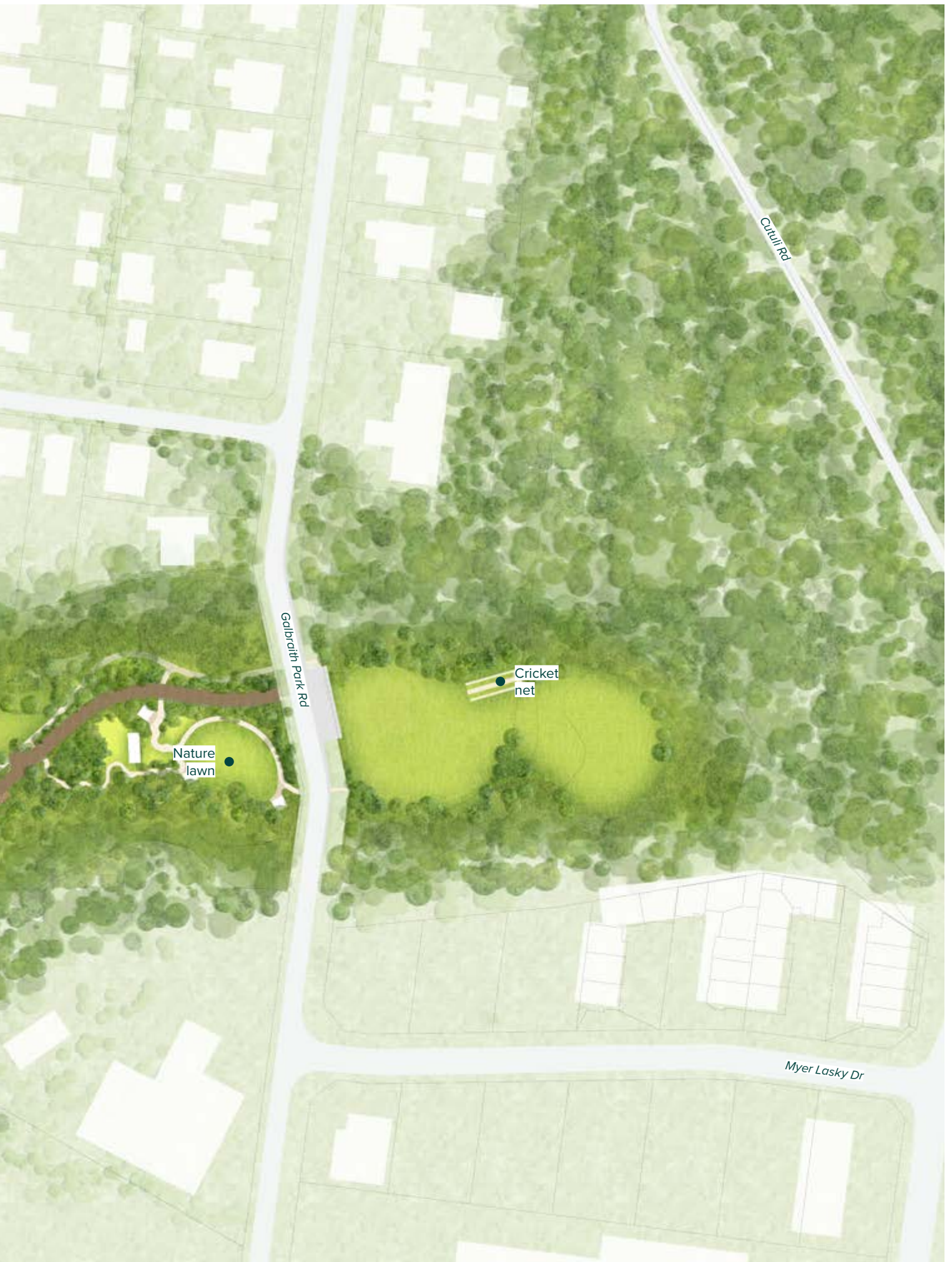

Figure 05

Galbraith Park Stage 01

1:2000



**Realising the
potential of
Galbraith Park,
a legacy for the
Cannonvale
community.**

Master Plan detail

The Galbraith Park Master Plan has been developed in response to a strong vision that seeks to create a regional destination that reconnects the community with nature. This chapter sets out the strategic direction for Galbraith Park, demonstrating its potential through a series of illustrative plans and visualisations of key spaces.

Community Zone



- | | | | | | |
|----|------------------------------------------------------------------------|----|-----------------------------------------------------------|----|------------------------------------------------------------------------|
| 01 | Drop off and bus zone to provide direct access to the community centre | 06 | BBQ pavilion overlooking the event lawn | 11 | Subtropical planters with canopy trees to provide shade |
| 02 | Community centre carpark adjacent to future road (stage 04) | 07 | Amenity block servicing both the event lawn and playscape | 12 | Re-vegetated creekline to improve ecological quality |
| 03 | Shade structure with misting garden | 08 | Parkland shelter set within the landscape | 13 | Nature trail to connect the community with the creek |
| 04 | Provision for pop-up activations | 09 | Parkland Drive for access and servicing | 14 | Informal discovery trail to connect the community with the environment |
| 05 | Amphitheatre overlooking the event lawn | 10 | Playscape carpark to provide direct access to playground | | |



Figure 03



The kickabout lawn forms the social anchor of the park - a flexible space designed for gatherings, markets and celebration. Shaded seating, informal terraces and open grass areas invite people to come together, relax and connect as a community.



View of the event lawn overlooking the community centre.



The playscape blends nature and creativity through climbing structures, water play and discovery trails that encourage exploration and intergenerational play. Framed by park pavilions, picnic shelters and shaded rest areas, it is a place for people of all ages and abilities.



View of the playscape.

Key spaces



Community square

A subtropical plaza that functions as the social heart of the park, accommodating festivals, markets and cultural events. With active street edges, it creates a strong address for the community centre - providing a natural meeting point for all ages.

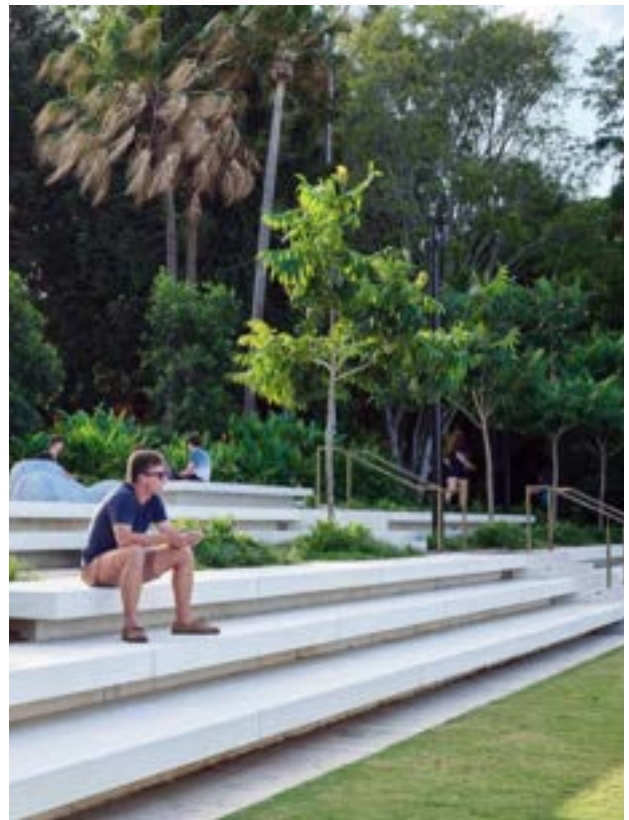

Community green

A generous open lawn framed by an amphitheatre, providing space for informal gatherings, concerts and community events. It is an outdoor 'living room', designed to bring the community together.



Playscape

A nature-based play environment that encourages exploration through sensory materials, varied terrain and water play. Designed as a signature destination for families, it blends play into the landscape to create an immersive experience.



Nature walk

A meandering boardwalk and trail network that follows the creek, inviting visitors to discover local ecologies. Interpretive signage and small gathering points create opportunities for quiet reflection, education and environmental stewardship.

Recreation Zone

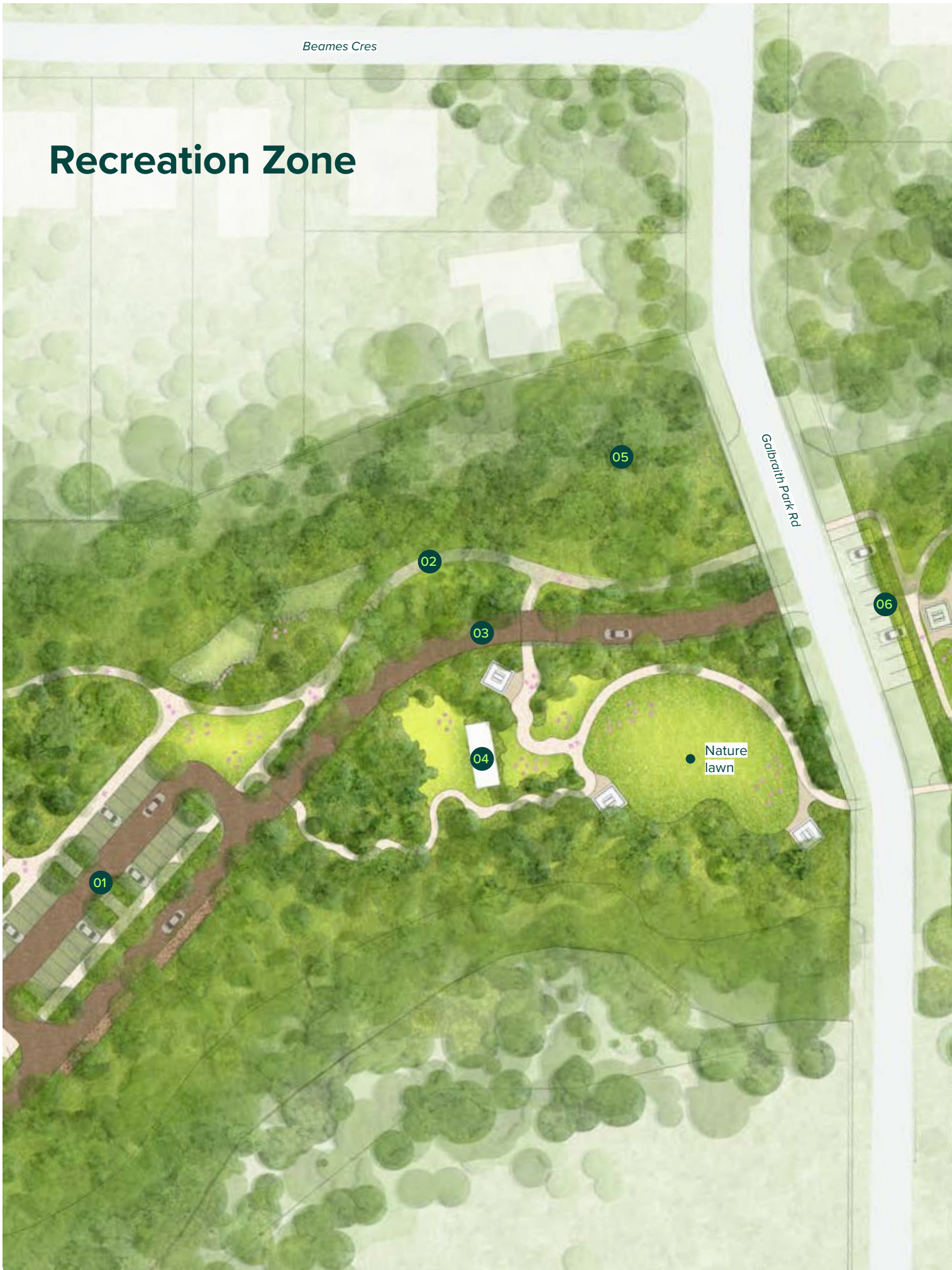

- 01 Carpark to provide direct access to the nature lawn
- 02 Nature trail to connect the community to the creek
- 03 Parkland Drive to provide direct access to parkland amenity

- 04 Parkland pavilion overlooking nature lawn
- 05 Re-vegetated creekline to improve ecological quality
- 06 Carpark to provide direct access to the multi-purpose court

- 07 Parkland shelter to provide shade and seating
Discovery trail to improve access to multi-purpose court and cricket nets



Figure 04





The multi-purpose court is a dynamic environment for movement and wellbeing. Integrating passive recreation lawns with active facilities, it welcomes both casual and organised activity, fostering a culture of health, inclusion and everyday enjoyment.



View to multi-purpose court.



The nature lawn offers a generous, open green space where people can slow down, relax and enjoy the calming presence of the adjacent waterway. Designed for passive recreation, it provides a comfortable setting for picnics, quiet gatherings, reading and everyday moments of pause within the broader parkland.



View to the nature lawn.

Key spaces



Multi-purpose court

A flexible sport and recreation space that supports basketball, futsal and informal play across age groups and abilities. The court will be a social attractor - a backdrop for youth culture and community expression.



Nature lawn

A generous, open green space adjacent to the creek. Designed for passive recreation, it provides a comfortable setting for picnics, gatherings and family-led activity.



Multi-purpose amenity

A multi-purpose amenity block with additional space for storage. Centrally located, outside of the high-risk flood area - it services the parkland and its community.



Park boulevard

A slow-speed shared street that balances the movement of bicycles, cars and pedestrians. Lined by trees, the boulevard frames the arrival into the park - reinforcing a calm, cool character.

**Building a
strong sense
of place, a park
that people are
proud of.**

Look and feel

The Galbraith Park Master Plan seeks to shape an enduring parkland - one that connects people and place. This chapter defines the future character of Galbraith Park, establishing the design elements that will contribute to its identity.

Shelter

The park shelters will provide shaded, welcoming spaces for gathering, rest, and reflection within the broader parkland. They will embody a refined simplicity - blending seamlessly into the natural setting and reinforcing the park's identity as a relaxed and immersive landscape.

- 01 Shelters will be constructed from sustainably sourced timber and exposed steel, reflecting a natural material palette inspired by the Whitsunday coast.
- 02 Their slender, floating rooflines will filter sunlight and create dappled shade reminiscent of the rainforest canopy.
- 03 Each shelter will be framed by low stone terraces and informal seating edges, inviting casual use and social interaction.
- 04 Materials will be robust and tactile, ensuring longevity in a coastal climate while maintaining visual warmth.
- 05 Shelters will be oriented to capture breezes and offer framed views across the play, recreation and nature zones.
- 06 Subtle artistic motifs and interpretive detailing will reference local flora, fauna and cultural stories, embedding the park's identity into its architecture.

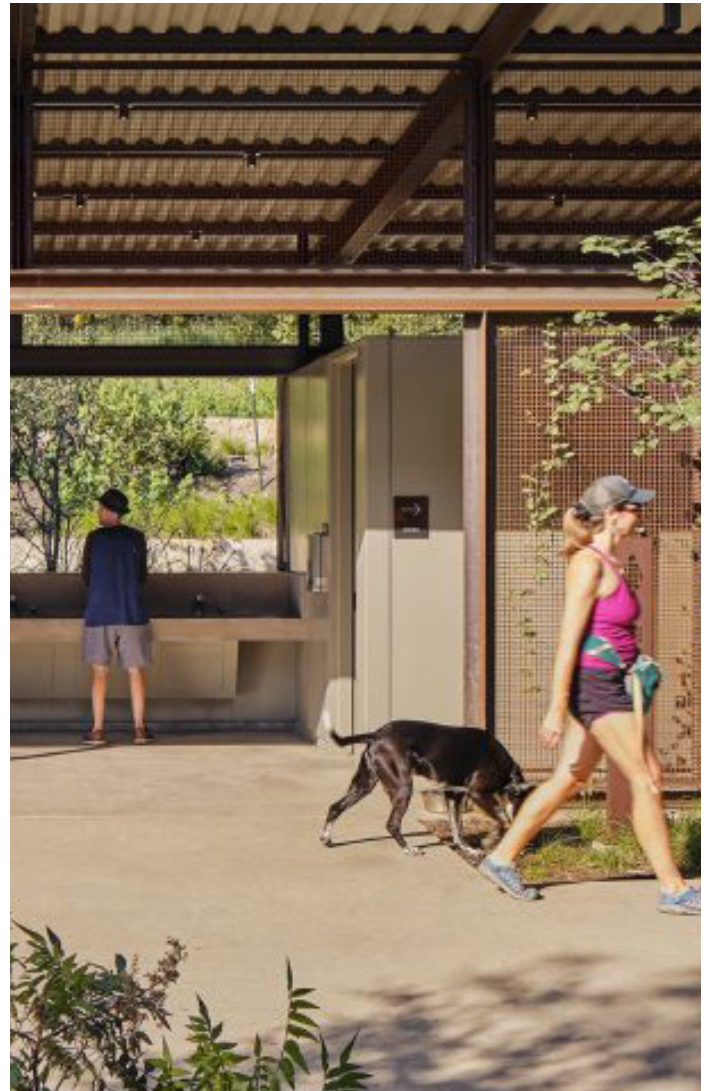

Responsive design

Built amenities will be light, permeable and flood-resilient - designed to withstand coastal conditions and seasonal change. Their form and character will respond to climate, landscape and local identity, while providing adaptable, shaded spaces for community use throughout the year.



Furniture

The furniture suite will establish a unified and enduring design language across the park. It will support comfort, accessibility and everyday use, while reinforcing the park's natural and understated character.

- 01 A cohesive family of benches, tables, bins and bollards will be used throughout the park, combining warm timber with blackened steel detailing.
- 02 Furniture will be crafted for comfort and inclusivity, with options that support a diversity of ages and abilities.
- 03 Curved and linear configurations will be used to define social nodes, edges and quiet areas across the park.
- 04 The suite will have a restrained visual presence, allowing the surrounding vegetation and landform to remain dominant.
- 05 All items will be coastal-resilient and easy to maintain, ensuring long-term durability.
- 06 Subtle engraved patterns and local references will appear on selected elements, offering moments of discovery and reinforcing a sense of place.



Inclusive design

Park furniture will be practical, durable and comfortable, designed to accommodate people of all ages and abilities. Placement will support rest, gathering and outlook - encouraging social interaction and leisurely enjoyment of the park.



Signage

Signage will play an important role in orientation and storytelling. It will be designed as a quiet layer within the landscape - clear, legible and consistent, while celebrating the park's identity and connection to Country.

- 01 A consistent family of wayfinding, interpretive and regulatory signs will be implemented using hardwood posts, corten or bronze-toned panels and etched text.
- 02 Signage will provide clear, concise communication with accessible language and universal pictograms.
- 03 Key signs will be strategically located along pathways and nodes, aligning with movement patterns and sightlines.
- 04 Interpretive panels will share stories of the Whitsunday landscape, ecology and Traditional Owner heritage.
- 05 Signs will be low in scale and unobtrusive, maintaining open views and a calm visual rhythm across the park.
- 06 Subtle lighting integration and reflective details will ensure safe visibility without disrupting the park's ambient night-time character.



Wayfinding

Signage will be legible, intuitive and seamlessly integrated into the landscape - positioned at key arrival points, trail intersections and community gathering spaces. It will use simple forms, durable materials and clear messaging to support wayfinding and strengthen sense of place.



Materiality

The material palette will anchor the park in its natural context, evoking warmth, authenticity and a sense of timelessness. Materials will be chosen for their texture, durability, and relationship to the local environment, ensuring a cohesive and grounded aesthetic.

- 01 Warm, earthy tones and natural textures will unify the park's built elements and surfaces.
- 02 Paving will combine textured concrete, decomposed granite and gravel, providing accessibility while retaining a natural feel
- 03 Gathering areas will be defined through subtle tonal variation, rather than strong contrast, maintaining visual softness.
- 04 Existing boulders and rock outcrops will be retained as sculptural features, integrating nature into the design.
- 05 Transitions between materials will be seamless and accessible, contributing to a coherent visual flow.
- 06 Locally sourced materials will be prioritised to reinforce authenticity and sustainability within the park's identity.

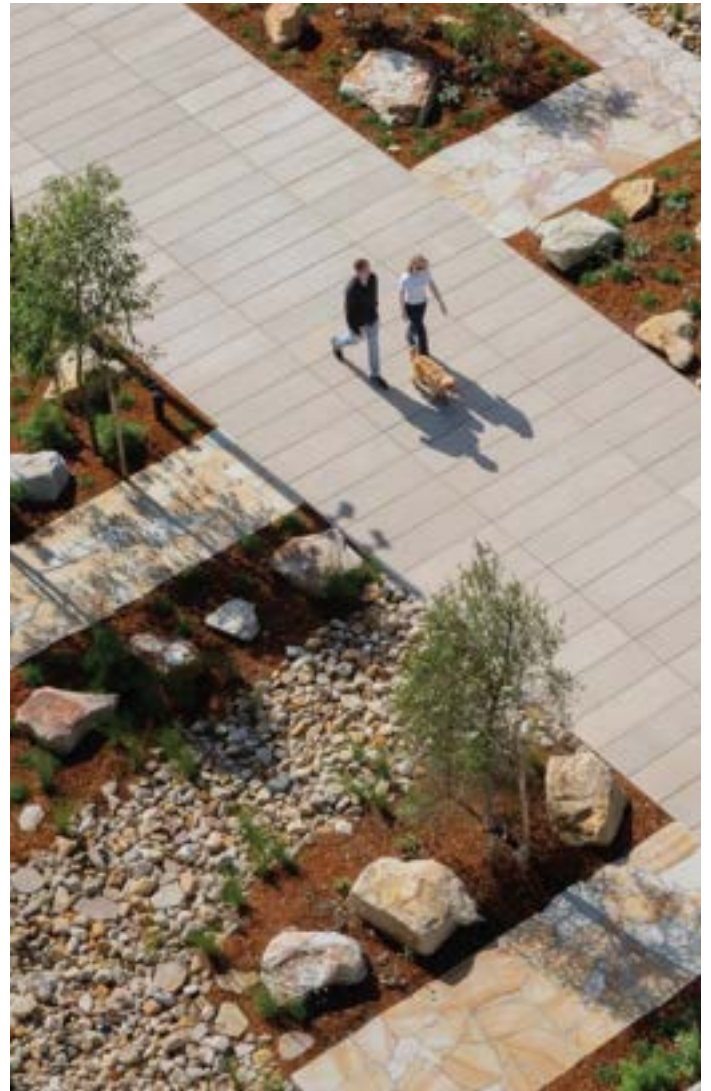

Authentic design

Materiality draw on colours, textures and finishes that reflect the coast, creeks and surrounding ranges. Hardscape and built elements will use a consistent, durable palette - timber battens, stone and exposed aggregate - chosen for resilience in a humid coastal environment.



Subtropical planting

The subtropical rainforest zones will form the immersive, shaded heart of Galbraith Park - lush, layered and ecologically rich. They will enhance biodiversity and create cool microclimates that invite exploration and pause.

- 01 Planting will create a multi-tiered canopy structure of tall shade trees, palms and dense understorey.
- 02 The palette will include broadleaf and glossy foliage species to evoke rainforest character and texture.
- 03 Meandering boardwalks and shaded paths will weave through dense planting, offering an immersive experience.
- 04 Vegetation will connect to riparian corridors, strengthening habitat and ecological continuity.
- 05 Seasonal variation in flowering and foliage will bring visual interest and dynamism throughout the year.
- 06 The rainforest zones will provide shelter and sensory richness, defining the park's cool and tranquil core.



Deeply green

Canopy trees, mid-storey vegetation and groundcovers will be arranged to define rooms of activity and quiet refuge, while reinforcing visual connections to the surrounding environment. This planting approach will encourage walking and gathering, and establish a distinct landscape identity.



Native planting

The Native Australian planting will define the park's open spaces - evoking the informal, sunlit character of Queensland's native woodlands. It will complement the rainforest zones through contrast and lightness, offering visual diversity and resilience.

- 01 Eucalypts, Melaleucas and native grasses will create open woodland structure with filtered light and long views.
- 02 Seasonal flowering in warm golds, reds and silvers will add colour and identity across the year.
- 03 Planting will be arranged in drifts and clusters, maintaining openness while creating movement and rhythm.
- 04 Pollinator-friendly and bird-attracting species will enhance habitat diversity across the park.
- 05 The palette will be low-maintenance and drought-tolerant, suited to the Whitsunday climate.
- 06 Groundcovers and grasses will combine with boulders, timber edges and gravel to create a soft, naturalistic finish.



Restorative design

Native species will be used to restore habitat, strengthen ecological corridors and reinforce a sense of local identity. Planting selections will be resilient, low-maintenance and supportive of biodiversity and pollinators.



