

## STATEMENT OF INFORMATION

Section 47AF of the Estate Agents Act 1980

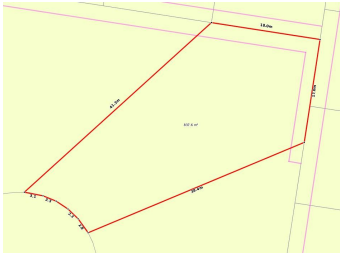

**13 ROSEMARY COURT, CARRUM DOWNS,**  4  2  -

## Indicative Selling Price

For the meaning of this price see [consumer.vic.au/underquoting](http://consumer.vic.au/underquoting)Price Range: **\$690,000 to \$750,000**

Provided by: Elyse Pomfret , Ray White Frankston

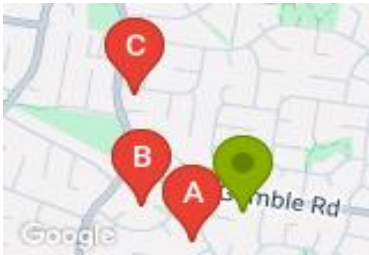
## MEDIAN SALE PRICE

**CARRUM DOWNS, VIC, 3201**

Suburb Median Sale Price (House)

**\$715,000**

01 October 2023 to 30 September 2024

Provided by: 

## COMPARABLE PROPERTIES

These are the three properties sold within two kilometres of the property for sale in the last six months that the estate agent or agents representative considers to be most comparable to the property for sale.

**13 DION DR, CARRUM DOWNS, VIC 3201** 4  2  2

Sale Price

**\$791,250**

Sale Date: 31/08/2024

Distance from Property: 193m

**10 EDENBRIDGE CRT, CARRUM DOWNS, VIC** 4  2  2

Sale Price

**\$705,200**

Sale Date: 07/08/2024

Distance from Property: 331m

**4 JULIANA DR, CARRUM DOWNS, VIC 3201** 3  2  2

Sale Price

**\$700,000**

Sale Date: 27/05/2024

Distance from Property: 554m



This report has been compiled on 11/10/2024 by Ray White Frankston. Property Data Solutions Pty Ltd 2024 - [www.pricefinder.com.au](http://www.pricefinder.com.au)

© The State of Victoria owns the copyright in the property sales data and reproduction of that data in any way without the consent of the State of Victoria will constitute a breach of the Copyright Act 1968 (Cth). The State of Victoria does not warrant the accuracy or completeness of the licensed material and any person using or relying upon such information does so on the basis that the State of Victoria accepts no responsibility or liability whatsoever for any errors, faults, defects or omissions in the information supplied.

# Statement of Information

## Single residential property located in the Melbourne metropolitan area

### Sections 47AF of the Estate Agents Act 1980

**Instructions:** The instructions in this box do not form part of this Statement of Information and are not required to be included in the completed Statement of Information for the property being offered for sale.

The Director of Consumer Affairs Victoria has approved this form of the Statement of Information for section 47AF of the *Estate Agents Act 1980*.

The estate agent or agent's representative engaged to sell the property is required to prepare this Statement of Information. It must be used when **a single residential property located in the Melbourne metropolitan area** is being offered for sale. The Determination setting out the local government areas that comprise the Melbourne metropolitan area is published on the Consumer Affairs Victoria website at **consumer.vic.gov.au/underquoting**. The indicative selling price in this Statement of Information may be expressed as a single price, or as a price range with the difference between the upper and lower amounts not more than 10% of the lower amount.

This Statement of Information must be provided to a prospective buyer within two business days of a request and displayed at any open for inspection for the property for sale.

It is recommended that the address of the property being offered for sale be checked at [services.land.vic.gov.au/landchannel/content/addressSearch](https://services.land.vic.gov.au/landchannel/content/addressSearch) before being entered in this Statement of Information.

### Property offered for sale

Address  
Including suburb and  
postcode

13 ROSEMARY COURT, CARRUM DOWNS, VIC 3201

### Indicative selling price

For the meaning of this price see [consumer.vic.gov.au/underquoting](https://consumer.vic.gov.au/underquoting)

Price Range: \$690,000 to \$750,000

### Median sale price

Median price

\$715,000

Property type

House

Suburb

CARRUM DOWNS

Period

01 October 2023 to 30 September 2024

Source



### Comparable property sales

These are the three properties sold within two kilometres of the property for sale in the last six months that the estate agent or agents representative considers to be most comparable to the property for sale.

#### Address of comparable property

#### Price

#### Date of sale

13 DION DR, CARRUM DOWNS, VIC 3201	\$791,250	31/08/2024
10 EDENBRIDGE CRT, CARRUM DOWNS, VIC 3201	\$705,200	07/08/2024
4 JULIANA DR, CARRUM DOWNS, VIC 3201	\$700,000	27/05/2024

This Statement of Information was prepared on:

11/10/2024